

Charm Aller-ROSA® Milk Test for Rinse Water

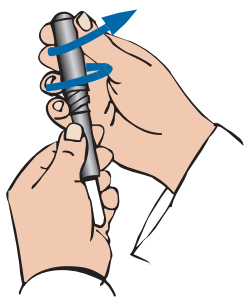

(1) Withdraw the swab by gently pulling and twisting the swab handle out of the swab body.

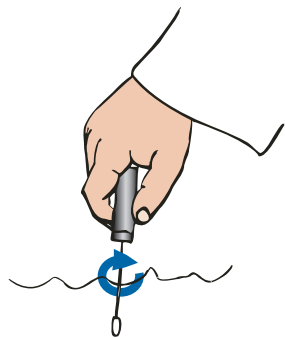

(2) Place the swab in rinse water sample (or control) and absorb for 20-30 seconds while swirling gently.

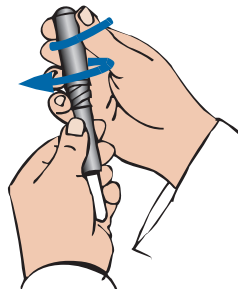

(3) Twist handle down to puncture seals to allow liquid to fully enter the vial.

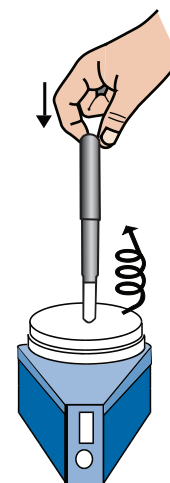

(4) Immediately vortex the swab for 20-30 seconds.

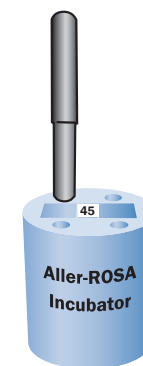

(5) Place the swab in the 45°C Aller-ROSA incubator for 10 minutes ± 30 seconds.

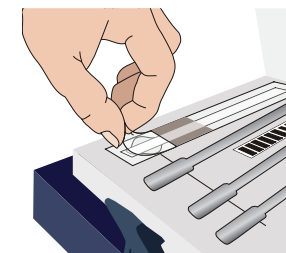

(6) Place strip in incubator and use tab to peel tape back to "Peel to here" line.

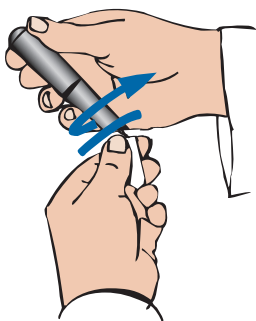

(7) Unscrew the vial.



(8) Use ROSA-pipet to deliver 300 µl into the lateral flow test strip well.



(9) Incubate for 5 minutes, but not more than 7 minutes.

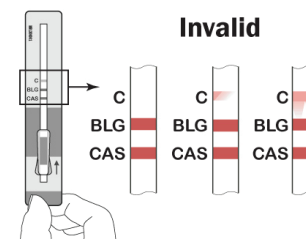

(10) The test is INVALID if any of the following are observed:
 C (Control) line is missing.
 C line is smeared or uneven.
 Sample is obscuring either the C or BLG or CAS (Test) lines.



(11) Within 3 minutes of completing incubation, insert visually valid test strip into ROSA Reader as shown. Slide completely into slot.
 Read results on QUIN channel specifically calibrated for Aller-ROSA Milk.